

# LKO MTP Hybrid 12 Multi-mode and 12 Single-mode Fibers + 3x12 AWG Power

Based on the MIL-DTL-5015 and VG 95234 standards, LK connectors adhere to the basic principles of strength and reliability of specified military components.

LK configurations and their wiring standards support secure connection for all Live and PA Rental business applications.

The LKO MTP Hybrid connection is a unique solution that gives the possibility of safe transport of 12 singlemode and 12 multimode fibers as well as carrying up to 20A single-phase.

It's optimal for powering active boxes and carrying signals in the two optical fiber standards with a single connection system cable.

It speeds up the cabling activities of "complex" systems without the need to expose fragile fiber connection types

It also allows to completely pre-wire rack systems with fiber optic interfaced devices, making them completely plug & play.

The LKO MTP Hybrid system is suitable for the transport of Video, Audio, Light, RF and Data signals, overcoming the maximum distances dictated by the physical limitations of copper and ensuring high performance for "any type" of installation.



- 12 single-mode OS2 fibers
- 12 multi-mode OM4 fibers
- 3x12 AWG up to 20A
- Based on military standard MIL-C-5015 and VG 95234
- for superior strength and reliability
- Easy and error-free mating for fast connections
- Excellent resistance against accidental unlocking caused by shocks and vibrations
- Audible snap in quick bayonet lock
- Cable version with easy-grip long metal locking ring
- Roller studs for easier coupling
- Body made of high quality aluminium with resistant Black finishing
- Guaranteed for over 1000 coupling operations
- Cable strain relief with anti-bending spring
- Operating temperature: -40° C / +85° C
- Storage temperature: -55° C / +85° C
- Free Fall: 500 falls, 1.2m
- Corrosion Resistance: 500 h Salt Spray
- Protection class: IP68 (mated or when connected, up to 5m)
- Dustproof shutters
- Typical loss IL/RL < 1.0 dB



## STANDARD WIRING



## Cable mount - Male

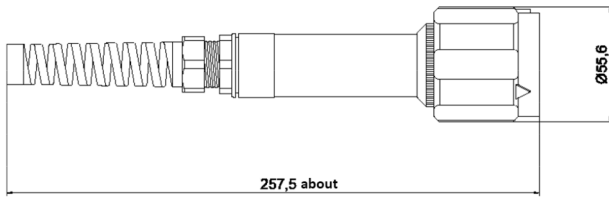

Code	Description
<b>LKO MTP24R 3 12M12S MV P</b>	LKO MTP24 multi/single mode fiber plus power line male with green rubber locking ring

## Cable mount - Female

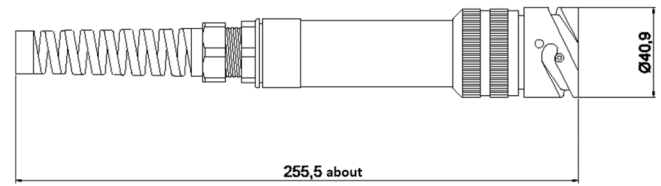

Code	Description
<b>LKO MTP24R 3 12M12S FV</b>	LKO MTP24 multi/single mode fiber plus power line female

## Panel mount - Male

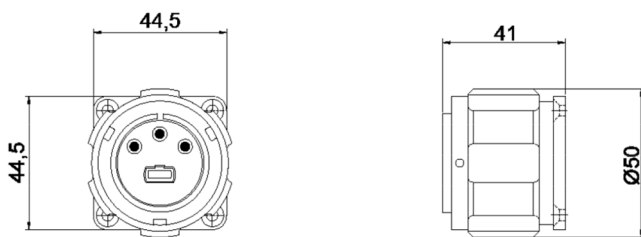

Code	Description
<b>LKO MTP24R 3 12M12S MP</b>	LKO MTP24 multi/single mode fiber plus power panel male

## Panel mount - Female

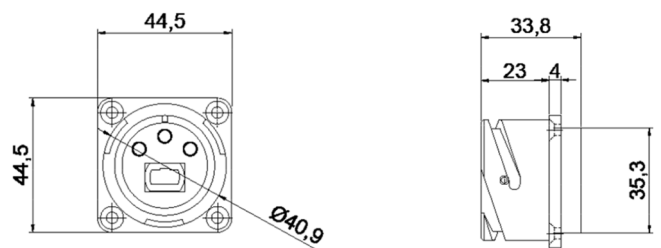

Code	Description
<b>LKO MTP24R 3 12M12S FP</b>	LKO MTP24 multi/single mode fiber plus power panel female

## Custom assemblies

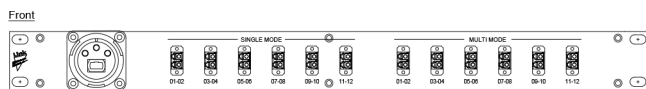

**BREAK-OUT BOX**

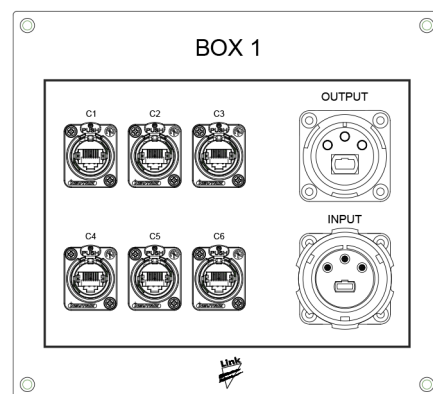

**WALL BOX**

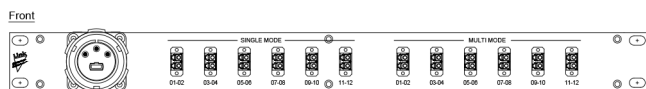

**BREAK-IN BOX**

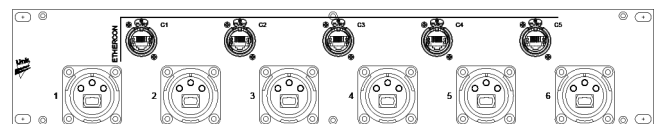

**CUSTOM BOX**